

Clams, gaskets, screws and pop nuts are not supplied by EXHAUSTO, unless the damper is mounted from factory.

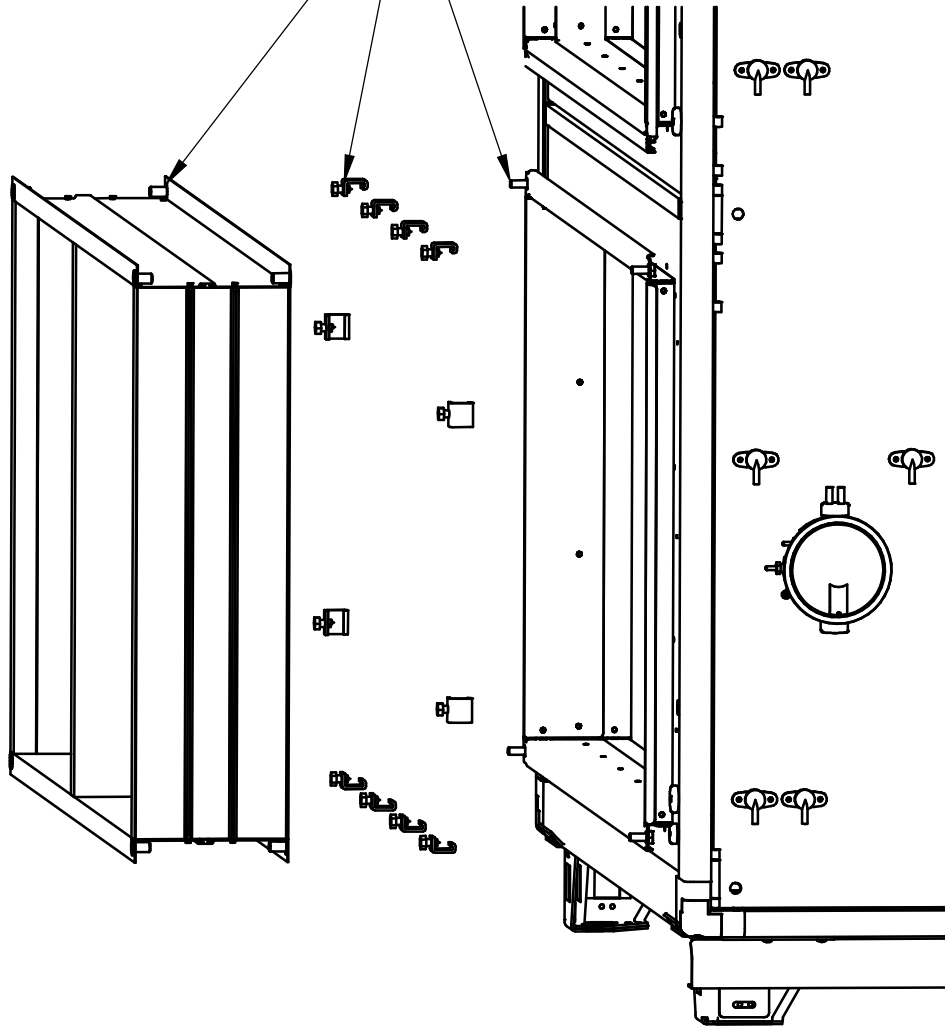

Dampersize		No. of clamps	
Height (mm)	Depth (mm)	In each end	In top and bottom
500	700	1	1
500	900	1	2
600	1200	1	2
600	1300	1	2
700	1400	1	3
800	1600	1	3
800	1800	1	4
900	2000	1	4
1000	2200	2	4
1000	2400	2	5
1200	2400	2	5

Project:
 Title: Assembly of METU dampers

EXHAUSTO

Draw. No.:

3006627

Material:
 Date: 30-03-2023
 Rev.: 30-03-2023

Rev. No.: A
 Approved by: DKHBJ
 Designer: DKBSP
 Format: A4
 EC No.:

Replaces:

* Control measurement

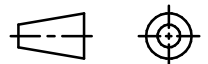

Unless otherwise specified tolerances are according to: